

# Kit 1626

CITROËN C4, 5-dr Hatchback, 10-

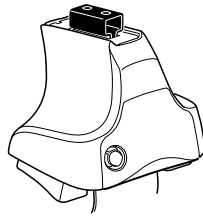

**754** Rapid System  
**480R** Rapid Traverse (North America)

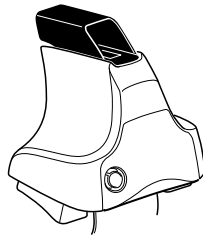
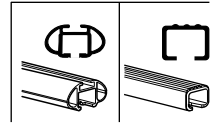

**480** Traverse (North America)

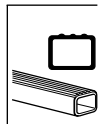

754 Rapid System  
480R Rapid Traverse (North America)

480 Traverse (North America)

23 mm bar	x2	23 mm bar	x2	17 mm bar	x1	23 mm bar	x2	23 mm bar	x2
23 mm bar	x2	23 mm bar	x2	23 mm bar	x2	23 mm bar	x2	23 mm bar	x2
23 mm bar	x2	23 mm bar	x2	23 mm bar	x2	23 mm bar	x2	23 mm bar	x2
23 mm bar	x2	23 mm bar	x2	23 mm bar	x2	23 mm bar	x2	23 mm bar	x2
23 mm bar	x2	23 mm bar	x2	23 mm bar	x2	23 mm bar	x2	23 mm bar	x2
23 mm bar	x2	23 mm bar	x2	23 mm bar	x2	23 mm bar	x2	23 mm bar	x2

1150	x2	313	x1
1151	x2	314	x1
		333	x1
		334	x1
		RR, PR, FL, RL	x1

1

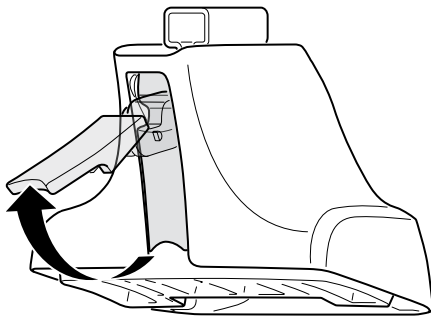

2



754 Rapid System  
480R Rapid Traverse  
(North America)

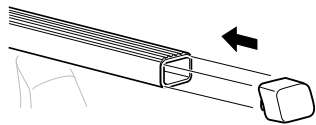
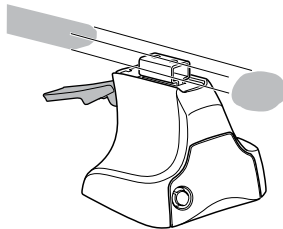

x4

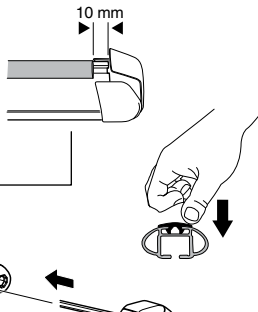
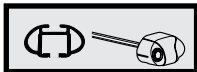

x4

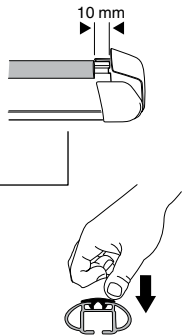
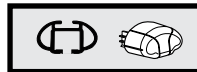

x4



480 Traverse  
(North America)

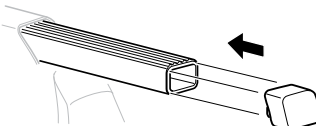
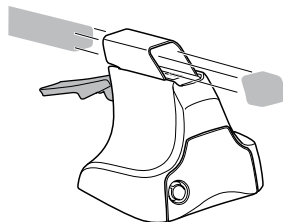

x4

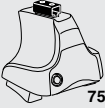
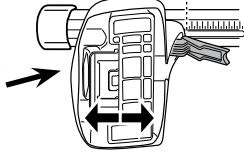
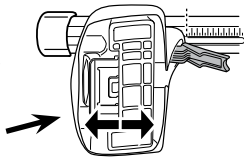
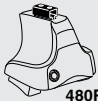
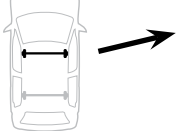
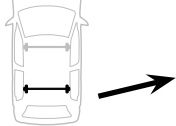
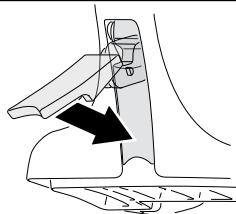
**3****754** Rapid System**X****CITROËN C4, 5-dr Hatchback, 10-****X****38****Y****CITROËN C4, 5-dr Hatchback, 10-****Y****32,5****3****480R** Rapid Traverse**480** Traverse**(North America)****CITROËN C4, 5-dr Hatchback, 10-****X inch****X mm****40 5/8"****1031 mm****CITROËN C4, 5-dr Hatchback, 10-****Y inch****Y mm****38 3/8"****976 mm****4**

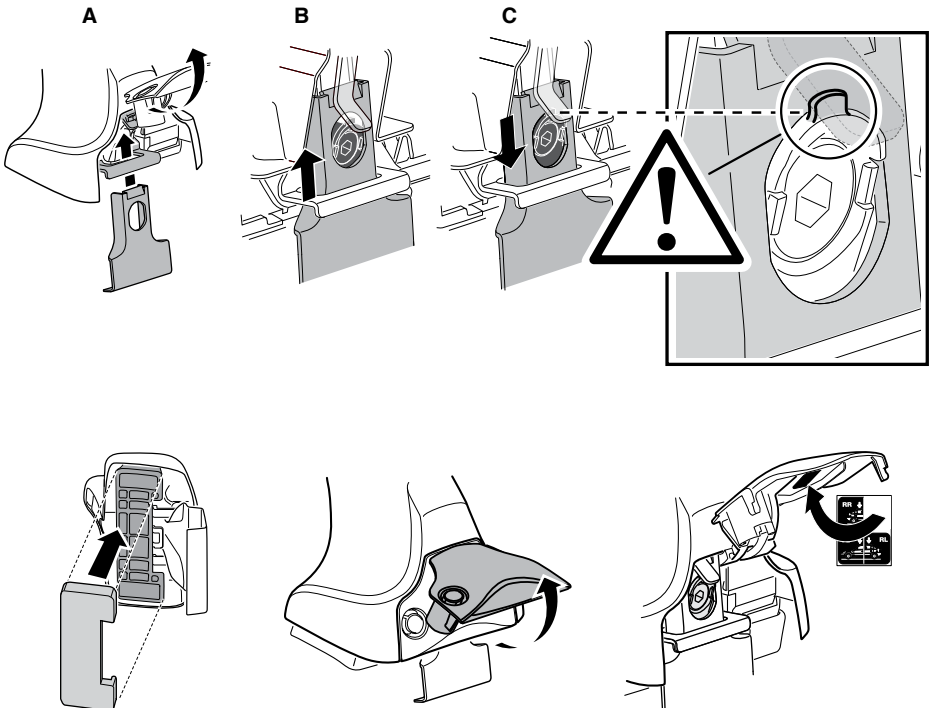
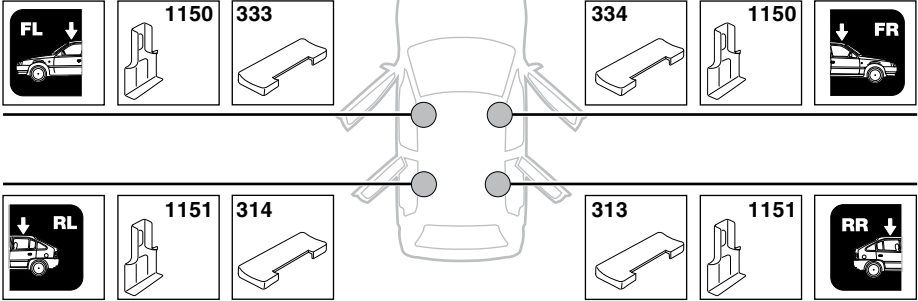
**5****CITROËN C4, 5-dr Hatchback, 10-**

6

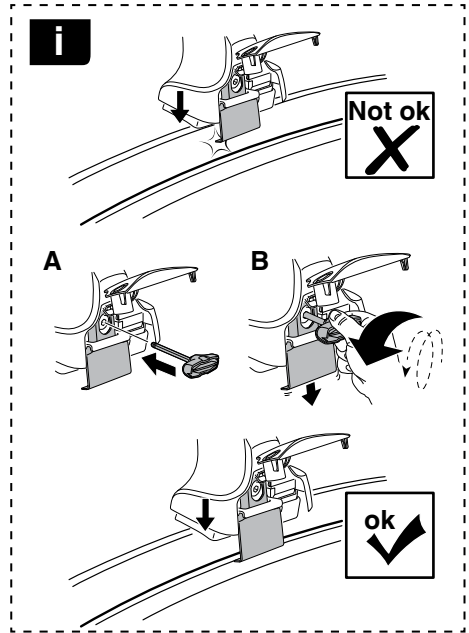
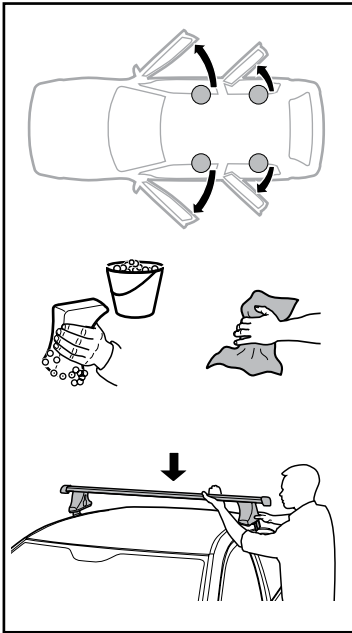

	X mm	Y mm	X inch	Y inch
<b>CITROËN C4, 5-dr Hatchback, 10-</b>	<b>210 mm</b>	<b>725 mm</b>	<b>8 1/4"</b>	<b>28 1/2"</b>

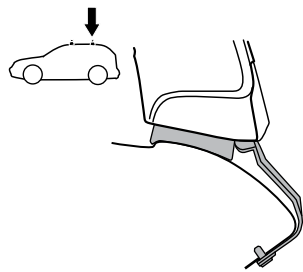
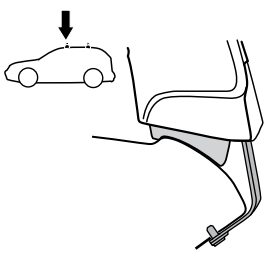
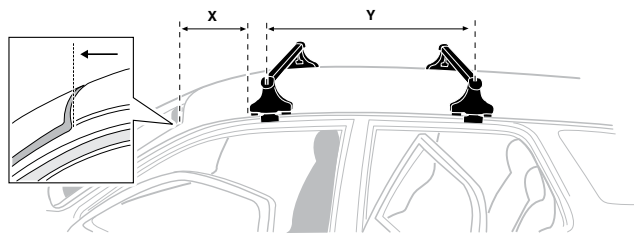

7

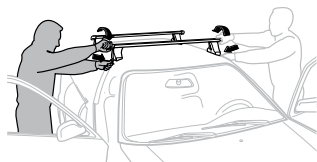

<b>GB/US</b>	Tighten alternately
<b>D</b>	Die Schrauben abwechselnd anziehen
<b>F</b>	Serrer alternativement chaque côté
<b>NL</b>	Afwisselend aan de linker- en de rechterkant aandraaien
<b>I</b>	Alternare il serraggio delle viti
<b>E</b>	Apretar alternativamente
<b>PT</b>	Aperte alternadamente
<b>S</b>	Dra åt växelvis
<b>FIN</b>	Kierrä vuorotellen
<b>EST</b>	Pinguldage vaheldumisi
<b>LAT</b>	Pielveiciet pamišus
<b>LIT</b>	Užsukinėkite pakaitomis
<b>PL</b>	Śruby dokręcaj naprzemiennie
<b>RU</b>	Загряивайте попеременно

<b>CZ</b>	Pokręřta багаžníka dokręřcaj dokręřcaj naprzemiennie.
<b>SK</b>	Dofahajte striedavo
<b>SLO</b>	Privijajte izmenično.
<b>HR</b>	Naizmjenočno zategnite
<b>HU</b>	Egymástól függetlenül szorítandó
<b>GR</b>	Σφιγγετε εναλλάξ
<b>TR</b>	Dönüşümlü sıkın

**中文** 交替拧紧

**한국어** 번갈아 가며 조이십시오.

**日本語** 交互に締め付けてください。

**ไทย** ชันในแบบสลับ

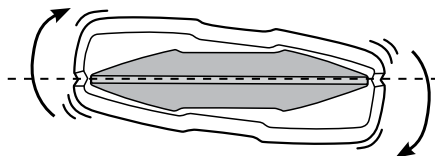
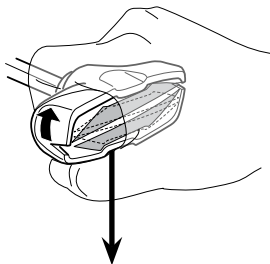
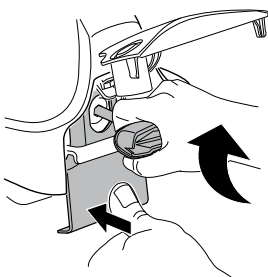
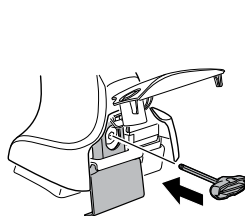

≈ 3 Nm

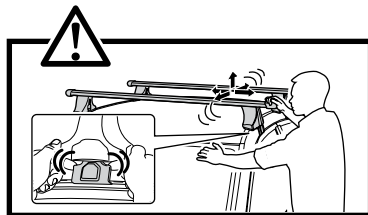
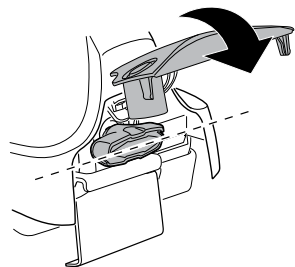

8

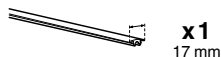

x1  
17 mm

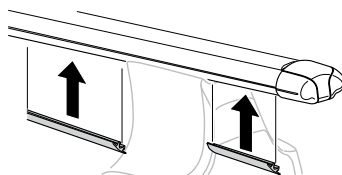

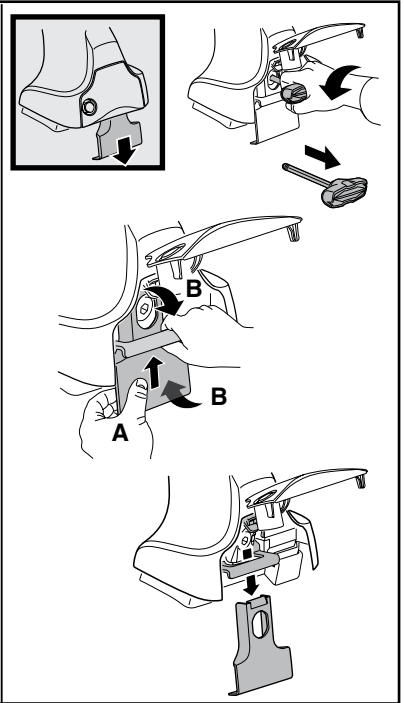
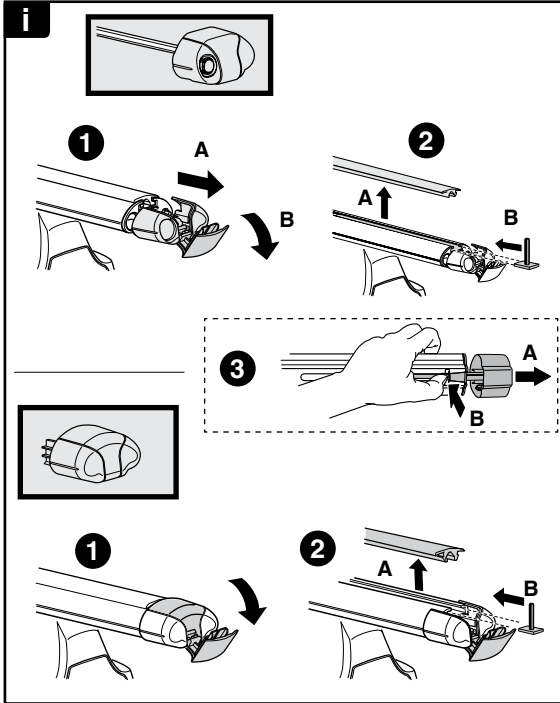
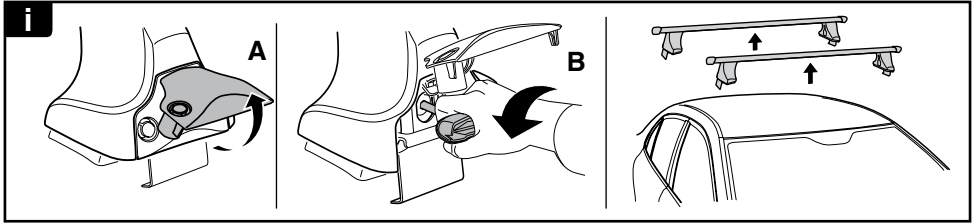

**THULE**  
SWEDEN  
**ONE  
KEY  
SYSTEM**

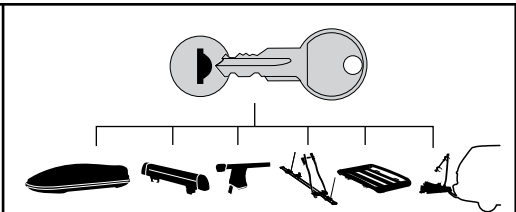

		(x4)
		(x6)
		(x8)
NA		(x10)
EUR		(x12)
ASIA		

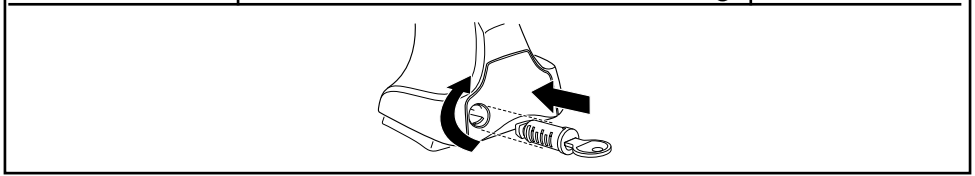

WW ▶ Thule Sweden AB, Box 69, 330 33 Hillerstorp, SWEDEN  
NA ▶ Thule Inc., 42 Silvermine Road, Seymour, Connecticut 06483, USA

info@thule.com  
customer.service@thule.com

www.thule.com