

Kit 1236

MITSUBISHI Challenger, 5-dr SUV, 96-05

MITSUBISHI L200 (Mk 1), 4-dr Double Cab, 95-05

MITSUBISHI Montero Sport, 5-dr SUV, *96-06

MITSUBISHI Pajero Sport, 5-dr SUV, 96-05

*North America

480R
754

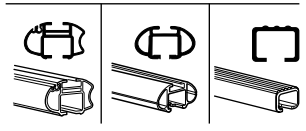
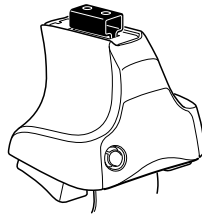

480

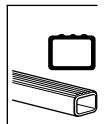
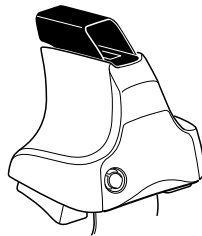

750

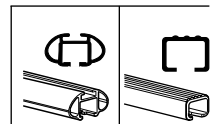
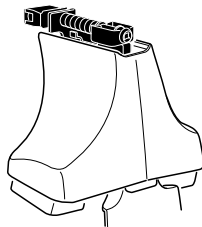

THULE[®]
SWEDEN

ISO 11154-E

Kit

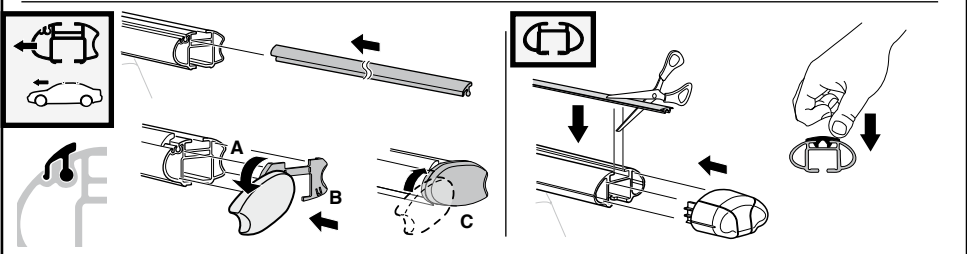
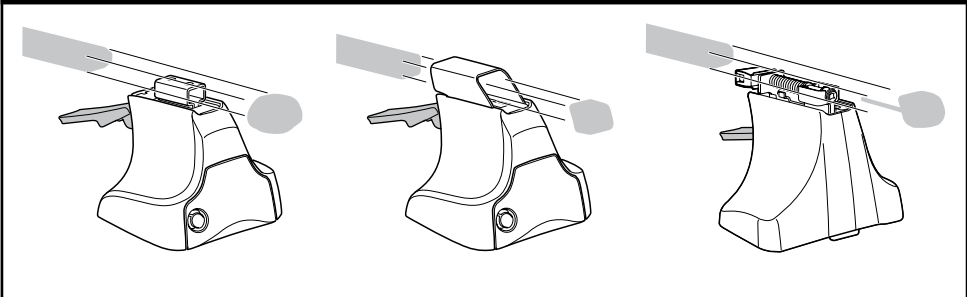



1

2

| | X |
|---|-------------|
| MITSUBISHI Challenger, 5-dr SUV, 96-05 | 35,5 |
| MITSUBISHI L200 (Mk 1), 4-dr Double Cab, 95-05 | 35,5 |
| MITSUBISHI Montero Sport, 5-dr SUV, *96-06 | 35,5 |
| MITSUBISHI Pajero Sport, 5-dr SUV, 96-05 | 35,5 |

1

2

| | Y |
|---|-------------|
| MITSUBISHI Challenger, 5-dr SUV, 96-05 | 35,5 |
| MITSUBISHI L200 (Mk 1), 4-dr Double Cab, 95-05 | 37 |
| MITSUBISHI Montero Sport, 5-dr SUV, *96-06 | 35,5 |
| MITSUBISHI Pajero Sport, 5-dr SUV, 96-05 | 35,5 |

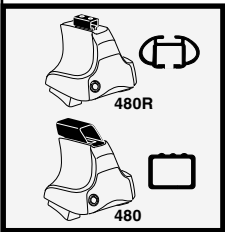

1

2

| | X inch | X mm |
|---|----------------|----------------|
| MITSUBISHI Challenger, 5-dr SUV, 96-05 | 39 5/8" | 1006 mm |
| MITSUBISHI L200 (Mk 1), 4-dr Double Cab, 95-05 | 39 5/8" | 1006 mm |
| MITSUBISHI Montero Sport, 5-dr SUV, *96-06 | 39 5/8" | 1006 mm |
| MITSUBISHI Pajero Sport, 5-dr SUV, 96-05 | 39 5/8" | 1006 mm |

1

2

| | Y inch | Y mm |
|---|----------------|----------------|
| MITSUBISHI Challenger, 5-dr SUV, 96-05 | 39 5/8" | 1006 mm |
| MITSUBISHI L200 (Mk 1), 4-dr Double Cab, 95-05 | 40 1/4" | 1021 mm |
| MITSUBISHI Montero Sport, 5-dr SUV, *96-06 | 39 5/8" | 1006 mm |
| MITSUBISHI Pajero Sport, 5-dr SUV, 96-05 | 39 5/8" | 1006 mm |

4

MITSUBISHI Challenger, 5-dr SUV, 96-05
 MITSUBISHI L200 (Mk 1), 4-dr Double Cab, 95-05
 MITSUBISHI Montero Sport, 5-dr SUV, *96-06
 MITSUBISHI Pajero Sport, 5-dr SUV, 96-05

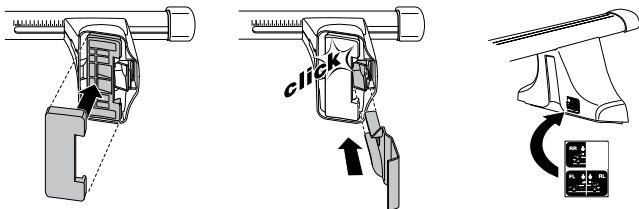
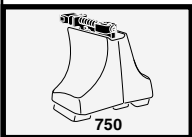
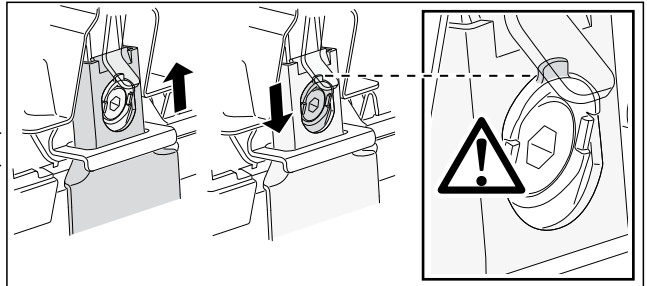
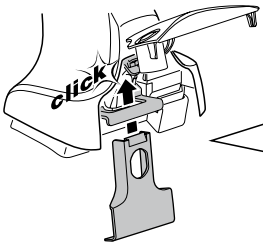
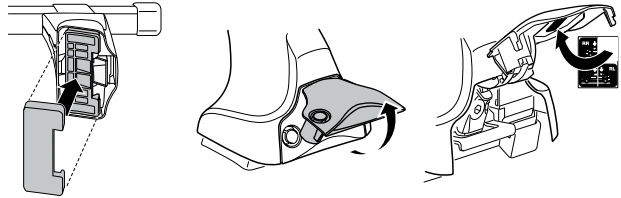
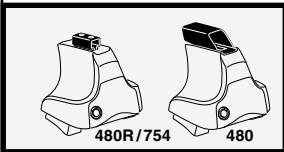
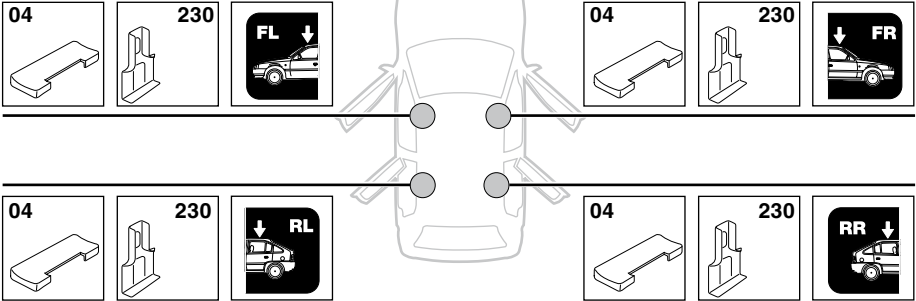

5

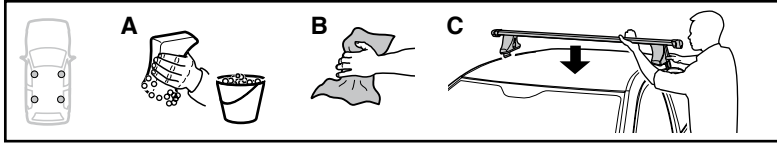

| | X mm | Y mm | X inch | Y inch |
|--|--------|--------|----------------------------------|----------------------------------|
| MITSUBISHI Challenger , 5-dr SUV, 96-05 | 440 mm | 700 mm | 17 ³ / ₈ " | 27 ¹ / ₂ " |
| MITSUBISHI L200 (Mk 1) , 4-dr Double Cab, 95-05 | 280 mm | 750 mm | 11 " | 29 ¹ / ₂ " |
| MITSUBISHI Montero Sport , 5-dr SUV, *96-06 | 440 mm | 700 mm | 17 ³ / ₈ " | 27 ¹ / ₂ " |
| MITSUBISHI Pajero Sport , 5-dr SUV, 96-05 | 440 mm | 700 mm | 17 ³ / ₈ " | 27 ¹ / ₂ " |

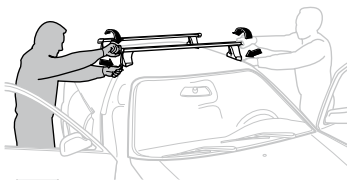
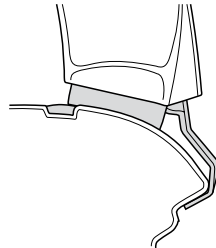
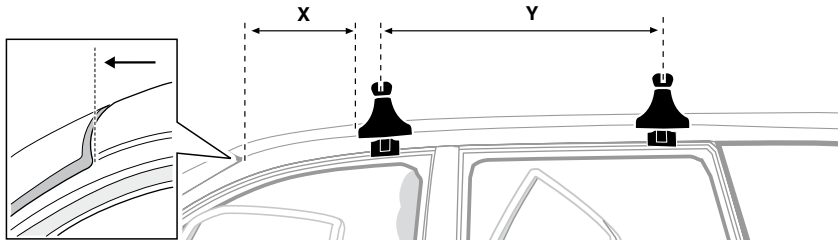

GB/US Tighten alternately

D Die Schrauben abwechselnd anziehen

F Serrer alternativement chaque côté

NL Afwisselend aan de linker- en de rechterkant aandraaien

I Alternare il serraggio delle viti

E Apretar alternativamente

PT Aperte alternadamente

S Dra åt växelvis

FIN Kierrä vuorotellen

EST Pinguldage vaheldumisi

LAT Pielvelciēt pamīšus

LIT Užsukinėkite pakaitomis

PL Śruby dokręcaj naprzemiennie

RU Затягивайте попеременно

CZ Pokręťta багаžnika dokręcaj dokręcaj naprzemiennie.

SK Doťahujte striedavo

SLO Privijajte izmenično.

HR Naizmjenično zategnite

HU Egymástól fűggetlenül szorítandó

GR Σφίγγετε εναλλάξ

TR Dönüşümlü sıkın

中文 交替拧紧

한국어 번갈아 가며 조이십시오.

日本語 交互に締め付けてください。

ไทย ชันในแบบสลับ

6



480R/754



480

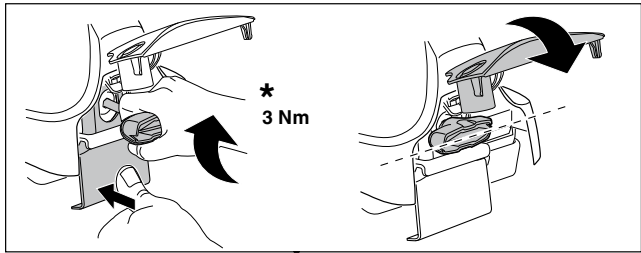
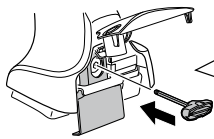

*
3 Nm

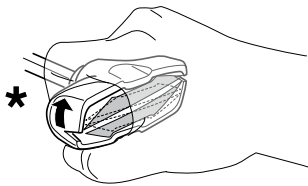

*



*
≈ 3 Nm

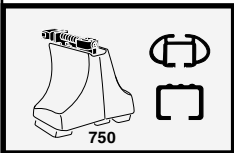
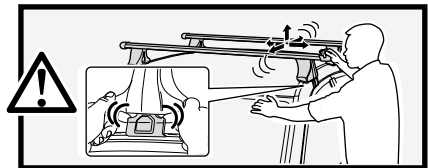

750

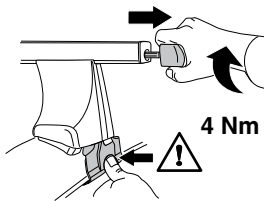

4 Nm

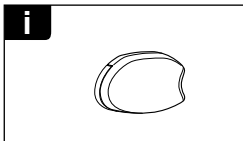
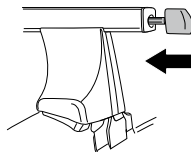

i

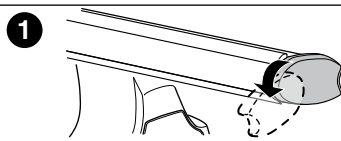

1

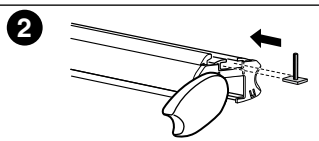

2

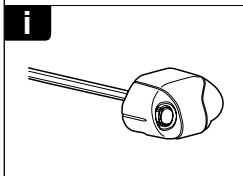

i

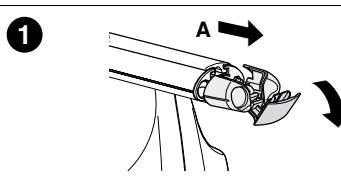

1

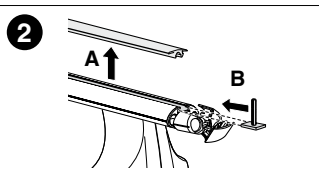

2

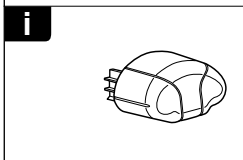

i

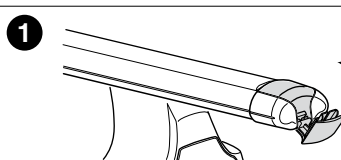

1

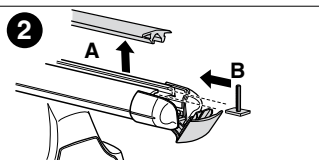

2



THULE
SWEDEN
**ONE
KEY
SYSTEM**



- 544 (x4)
- 596 (x6)
- 588 (x8)
- NA 510 (x10)
- EUR 452 (x12)
- ASIA



WW ▶ Thule Sweden AB, Box 69, 330 33 Hillerstorp, SWEDEN
NA ▶ Thule Inc., 42 Silvermine Road, Seymour, Connecticut 06483, USA

info@thule.com
customer.service@thule.com

www.thule.com



www.thuleprofessional.com



customer.service@thule.com



Thule Inc., 42 Silvermine Road, Seymour, Connecticut 06483, USA
Thule Sweden AB, Box 69, 330 33 Hillerstorp, SWEDEN

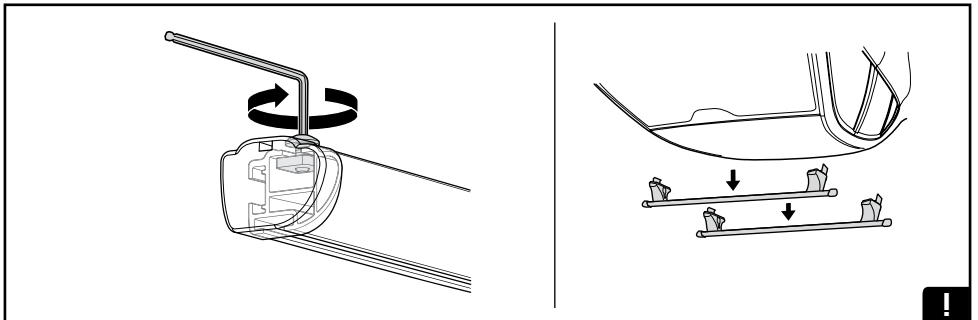
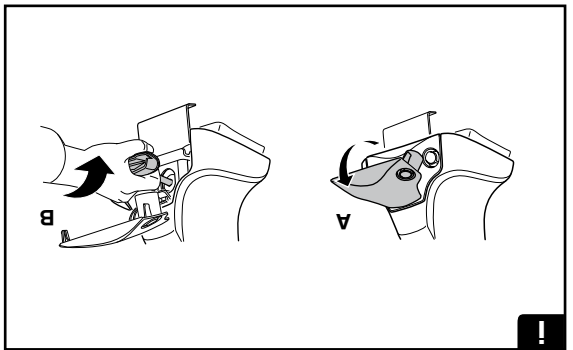
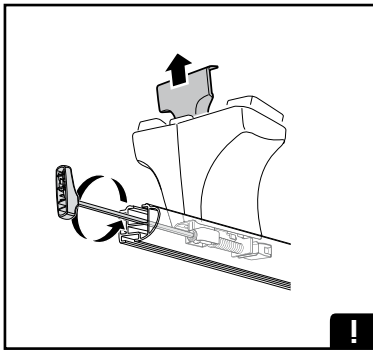
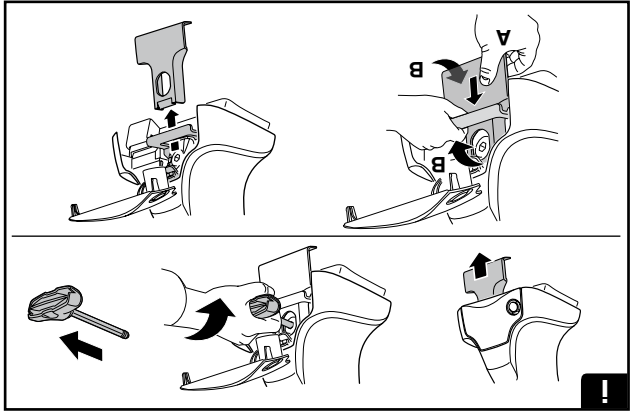
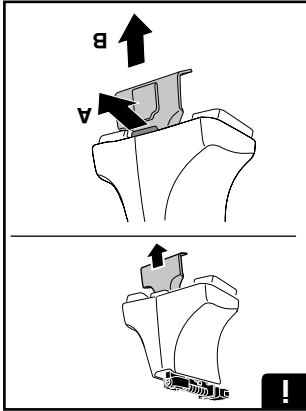

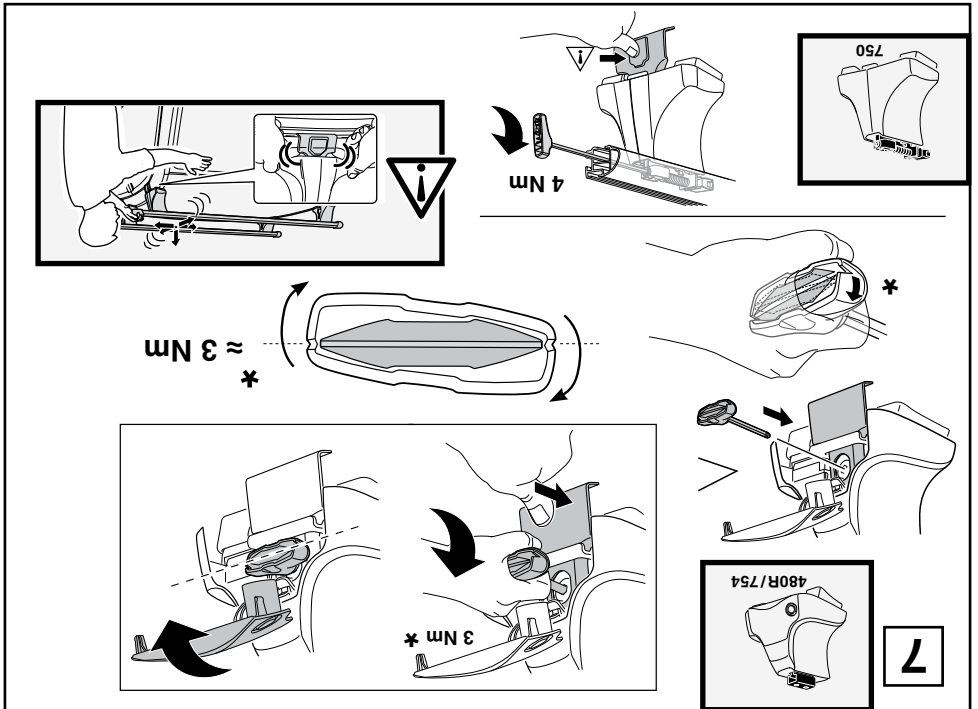
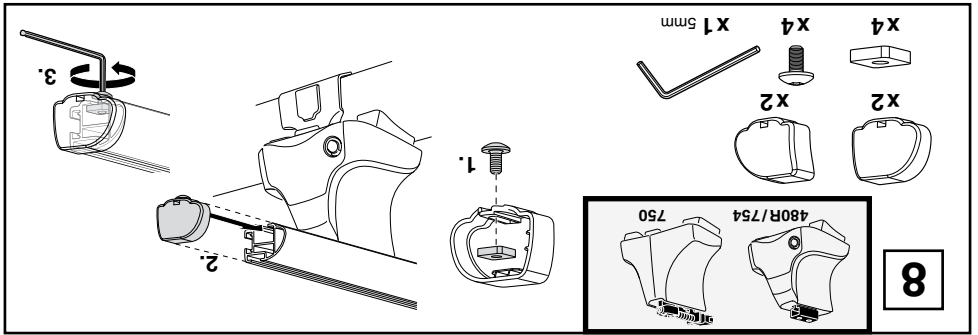
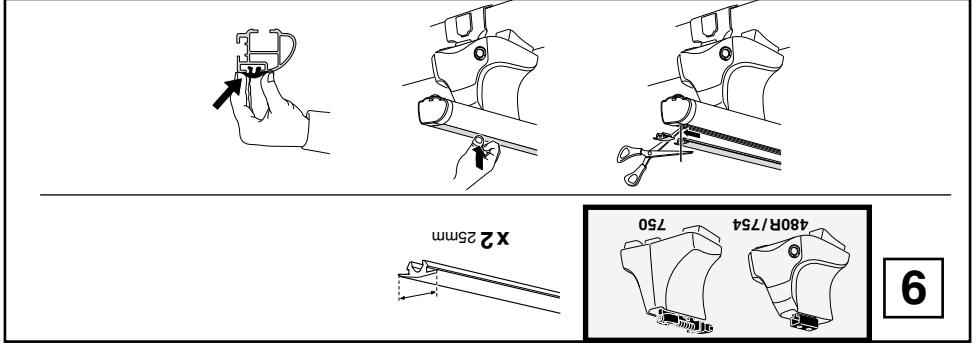

- S** Dra åt växelvis
- PT** Aperte alternadamente
- E** Apretar alternativamente
- I** Alternare il serraggio delle viti
- NL** de rechterkant aan de linker- en Afwisselend aan de linker- en cote
- F** Serrer alternativement chaque cote
- D** Die Schrauben abwechselnd anziehen
- GB/US** Tighten alternately

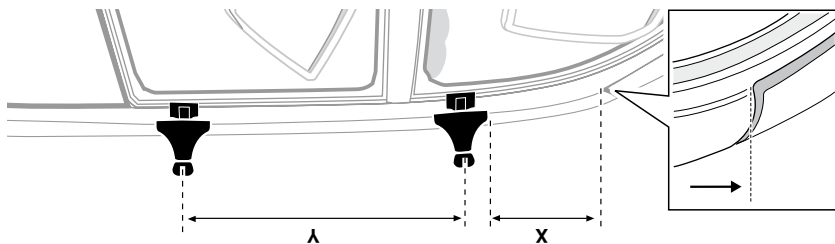
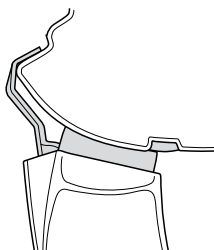
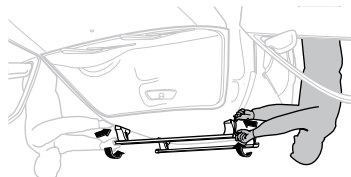

| | | | | |
|--|--------|--------|----------------------------------|----------------------------------|
| MITSUBISHI Challenger, 5-dr SUV, 96-05 | 440 mm | 700 mm | 17 ³ / ₈ " | 27 ¹ / ₂ " |
| MITSUBISHI L200 (Mk 1), 4-dr Double Cab, 95-05 | 280 mm | 750 mm | 11 " | 29 ¹ / ₂ " |
| MITSUBISHI Montero Sport, 5-dr SUV, *96-06 | 440 mm | 700 mm | 17 ³ / ₈ " | 27 ¹ / ₂ " |
| MITSUBISHI Pajero Sport, 5-dr SUV, 96-05 | 440 mm | 700 mm | 17 ³ / ₈ " | 27 ¹ / ₂ " |

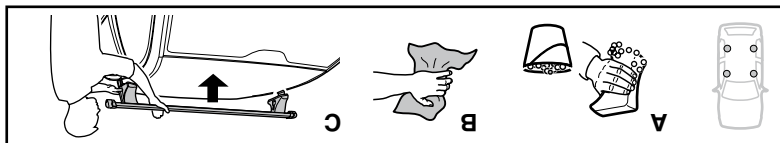

6

- FIN** Kierrä vuorotellen
- EST** Pinguldage vaheldumisi
- LAT** Pīvelciēt pamīšus
- LIT** Užsukinėkite pakaitomis
- PL** Śruby dokręcaj naprzemiennie
- RU** Затягивайте болты попеременно
- CZ** Pokrétá bagazníka dokrétáj dokrétáj naprzemiennie
- SK** Dotiahnujte striedavo
- SLO** Privijajte izmenično
- HR** Naizmjerno zategnite
- HU** Egyenlő időközönként
- GR** Σφιγγετε εναλλάξ
- TR** Dönümlü sıkın
- 中文** 交替拧紧
- 한국어** 번갈아 가며 조이십시오.
- 日本語** 交互に締め付けてください。
- ไทย** หมุนสลับไปมา

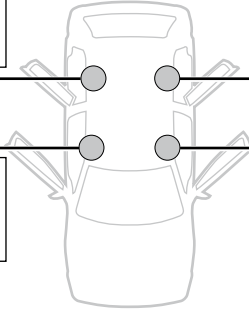
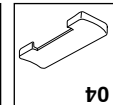
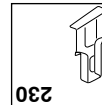
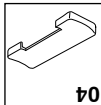
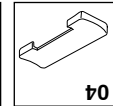
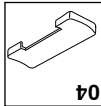
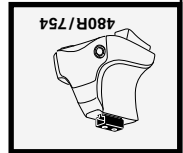
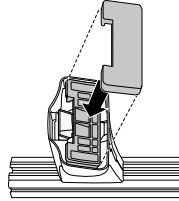
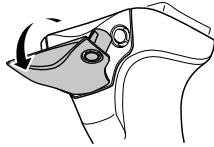
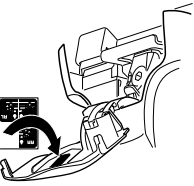
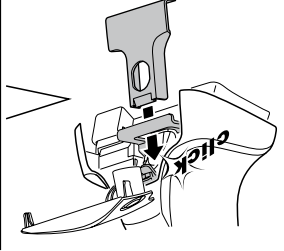
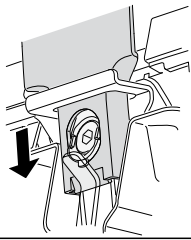
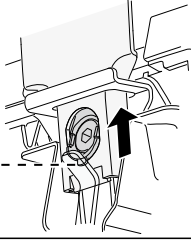
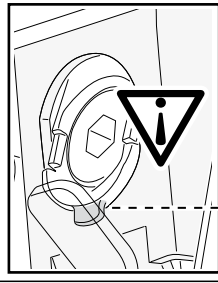
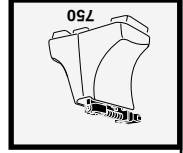
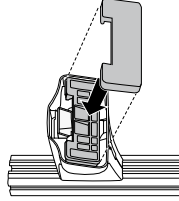
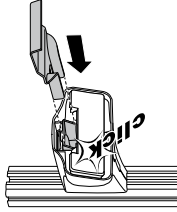
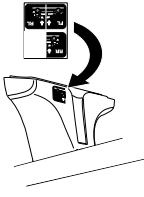

MITSUBISHI Challenger, 5-dr SUV, 96-05
 MITSUBISHI L200 (MK 1), 4-dr Double Cab, 95-05
 MITSUBISHI Montero Sport, 5-dr SUV, 96-06
 MITSUBISHI Pajero Sport, 5-dr SUV, 96-05

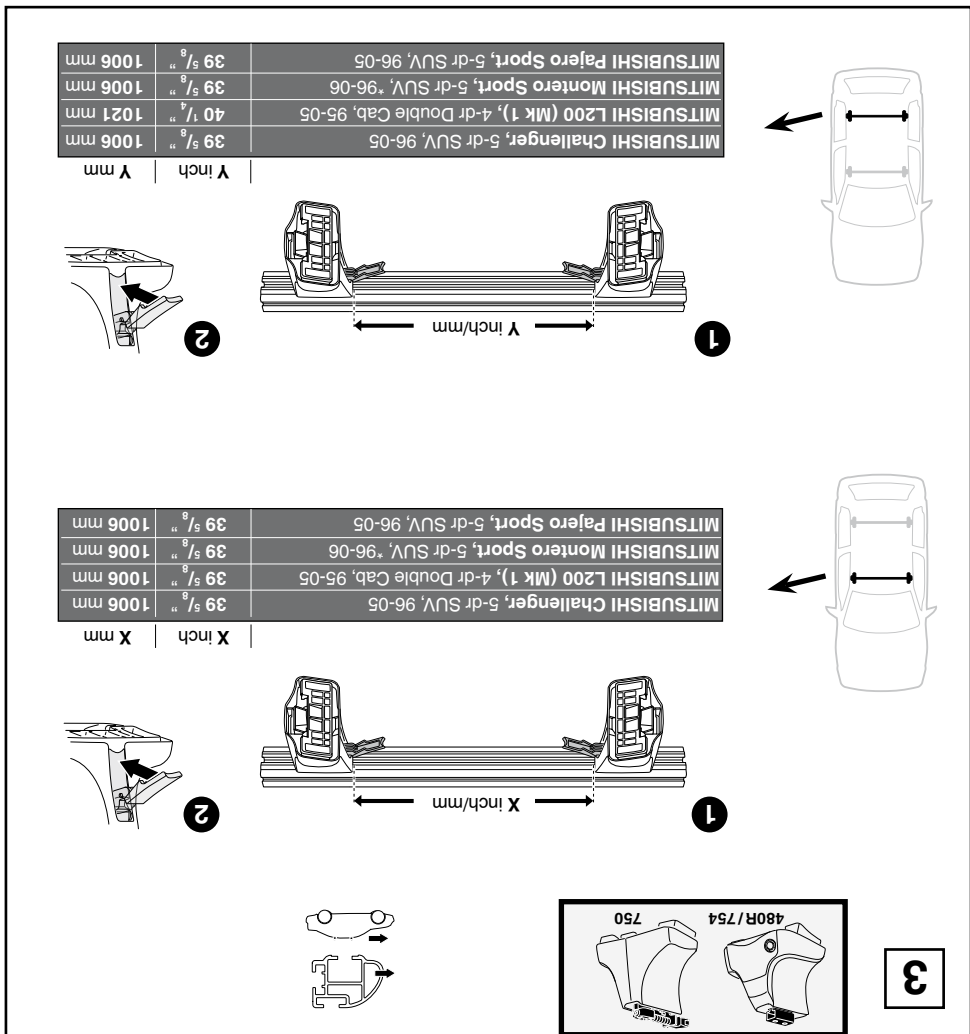
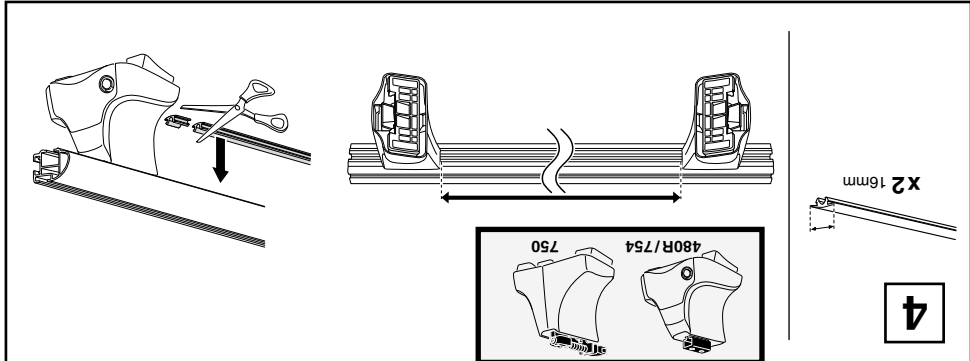

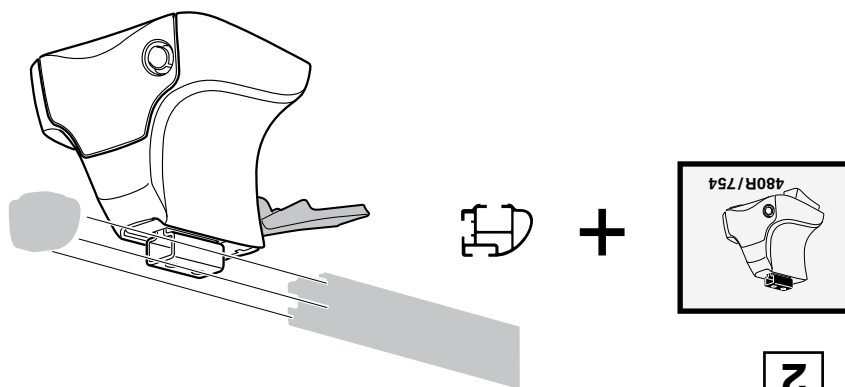
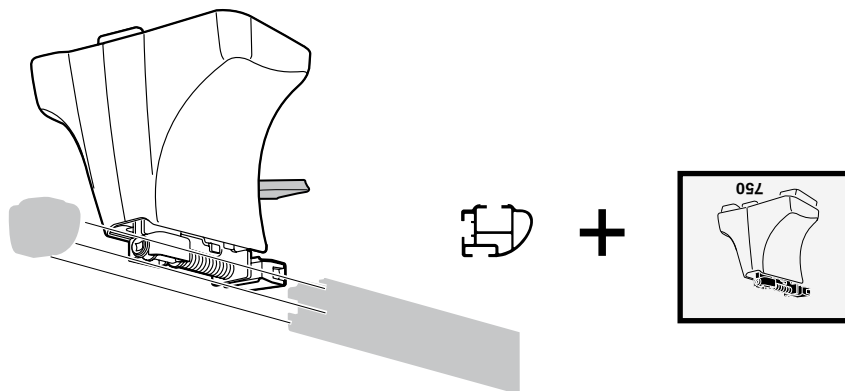

2

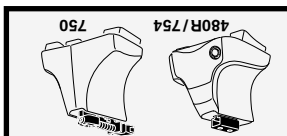
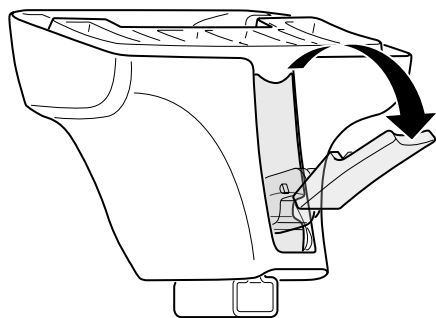

1

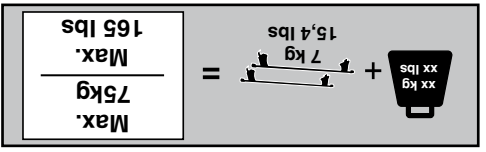
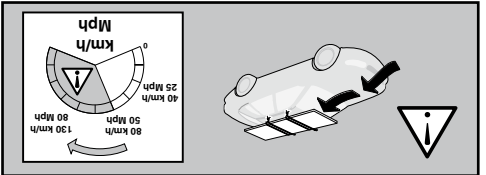
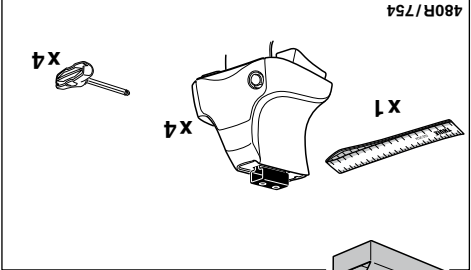
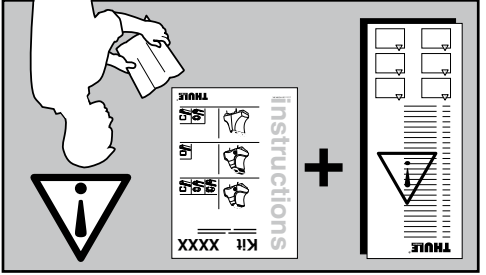
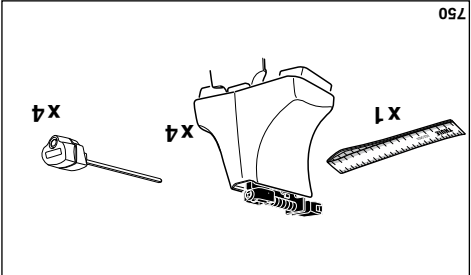
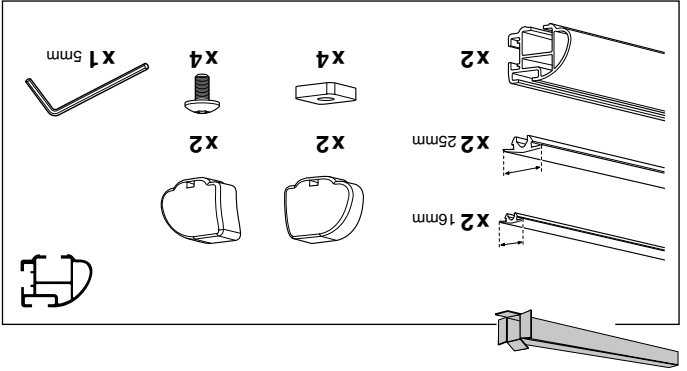
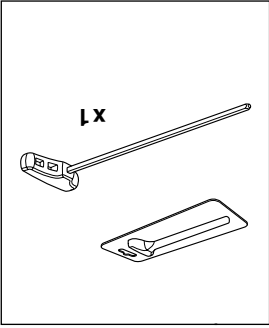
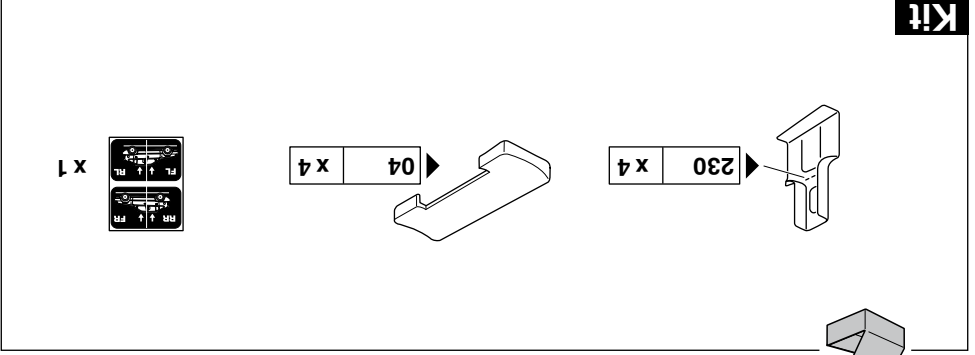

instructions

Kit 1236

MITSUBISHI Challenger, 5-dr SUV, 96-05
 MITSUBISHI L200 (Mk 1), 4-dr Double Cab, 95-05
 MITSUBISHI Montero Sport, 5-dr SUV, *96-06
 MITSUBISHI Pajero Sport, 5-dr SUV, 96-05
 *North America

480R
754

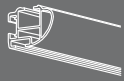
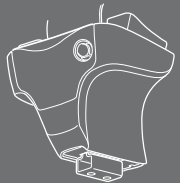

750

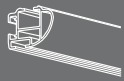
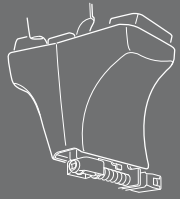

THULE
 SWEDEN
 PROFESSIONAL

ISO 11154-E