



RHINO-RACK

AERODYNAMIC & HEAVY DUTY ROOF RACK SYSTEMS

CXB COMMERCIAL RAIL FITTING INSTRUCTION.

**YOUR RHINO - RACK IS DESIGNED AND MANUFACTURED IN AUSTRALIA TO MEET THE STRINGENT REQUIREMENTS OF AUSTRALIAN STANDARD AS1235-2000.
ONLY USE RHINO - RACK APPROVED ACCESSORIES.**

Before fitting the commercial Rail Roof Rack, wash and clean the roof rails to remove dirt and grime from the rails.

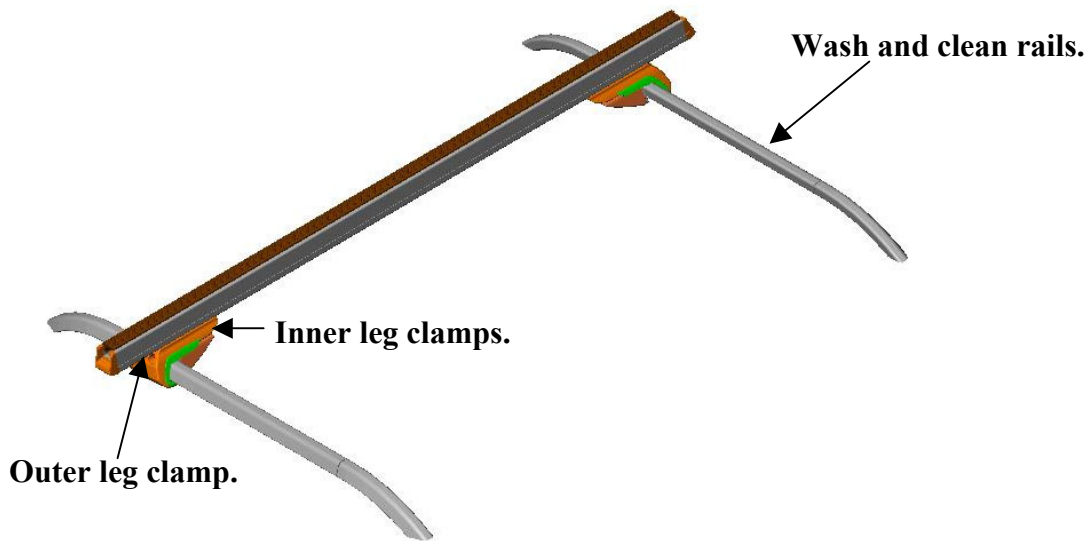

Fitting the leg assembly to the roof rails.

Slide the leg assembly into the commercial crossbar both ends as per the diagrams.

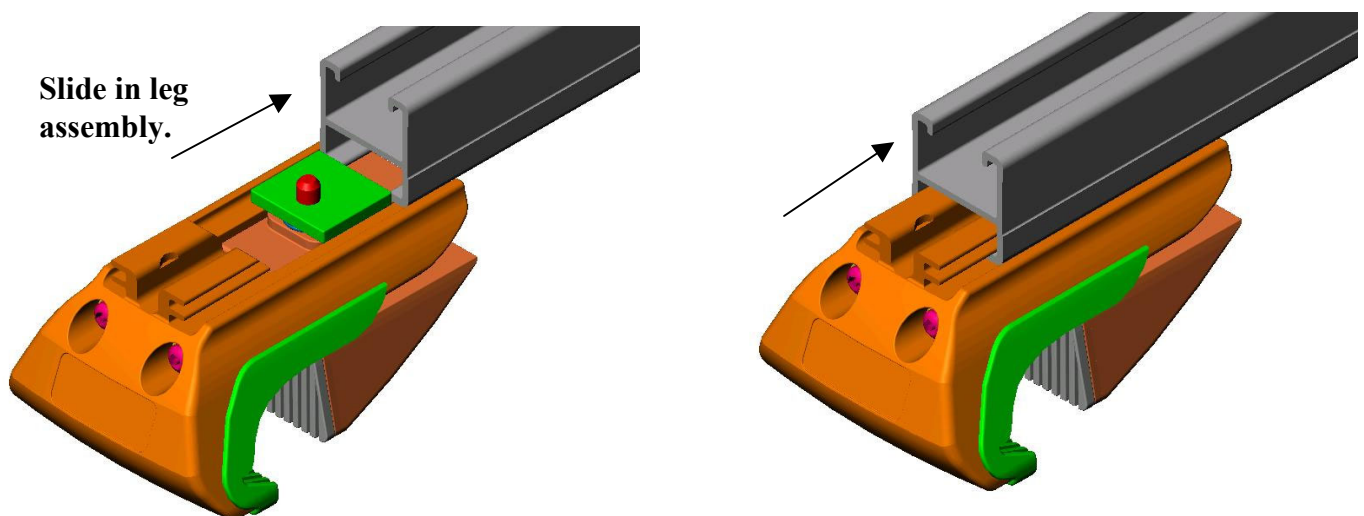

The front and rear leg assemblies are set open to fit over the vehicles roof rail, place the rails roof rack over the rails so that the leg assembly locate on top of the rails. Position the roof rack to suit your load requirements such as alloy tray, luggage basket, skis, surfboards etc.

Leg assembly over the rails.

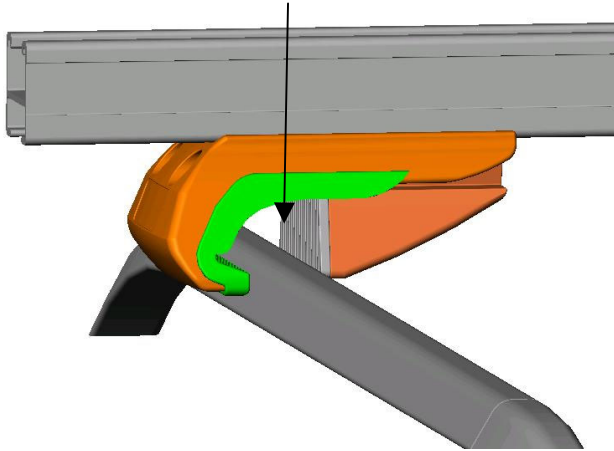

Leg assembly onto the

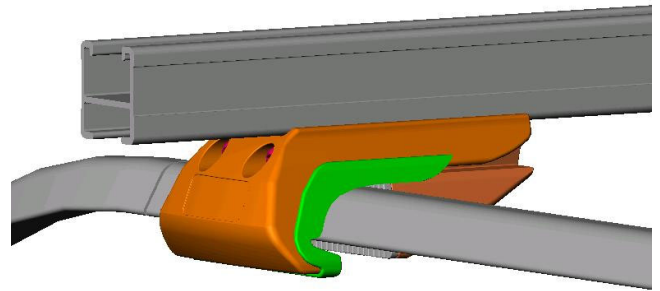

Pull the inner and outer clamp legs together around the rails. Adjust the commercial crossbar so that the crossbar over hang is equal both sides, finger tighten the crossbar attachment bolt as per the diagram.

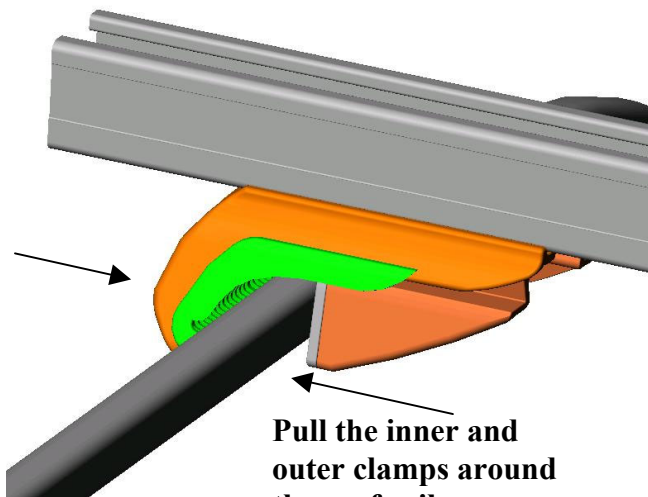

Pull the inner and outer clamps around the roof rails.

Crossbar attachment bolt.

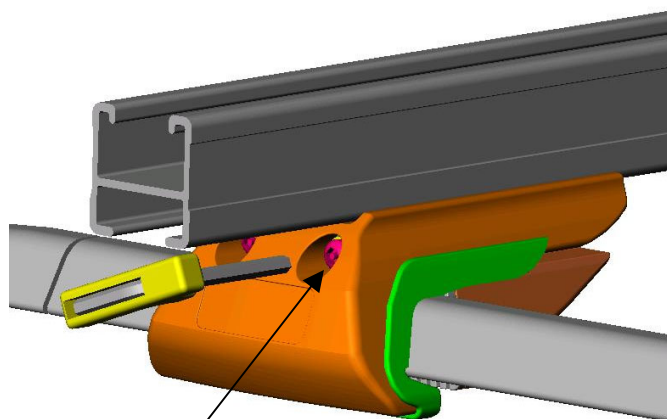
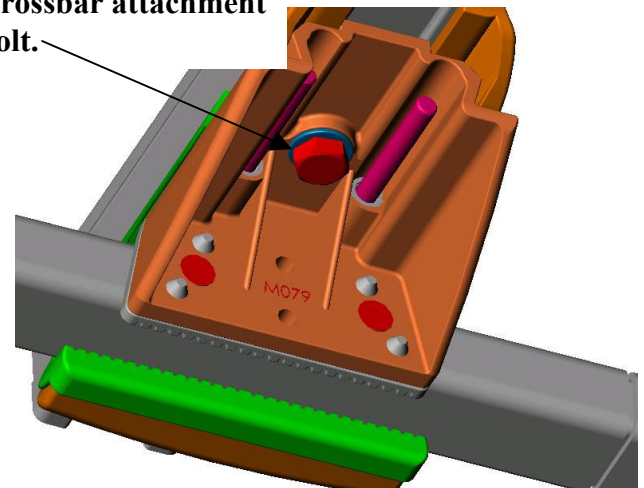

Security leg clamp bolts.

Using the security Allen key provided, tighten both leg clamp bolts equally, the outer clamp leg will move in towards the inner clamp leg. The leg assembly on some vehicles will lift as the security bolts are tightened. **Do not fully tighten the security bolts** as final tightening occurs later. Check that the outer clamp leg rubber seal has folded out over the roof rails.

Check the crossbar over hang is equal both sides, readjust if required. Fully tighten the security leg clamp bolts, and then the crossbar attachment bolts, using a 13mm spanner.

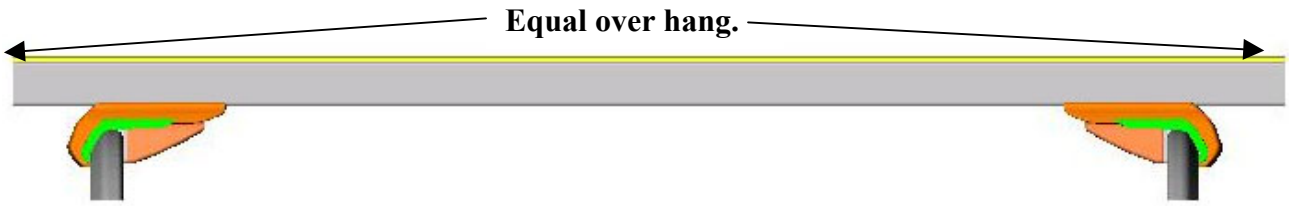

Fitting the end caps and rubber buffer strip.

Using a rubber mallet knock the end caps into the crossbars, insert the rubber buffer strip fully into the crossbar as per the diagrams.

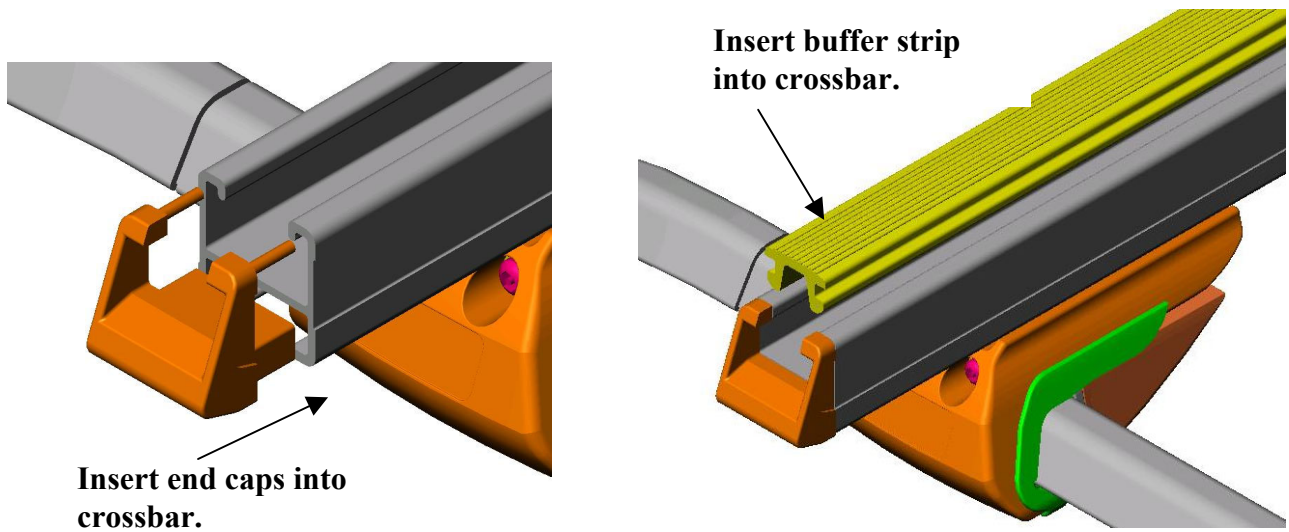

Check buffer strip is fully inserted.

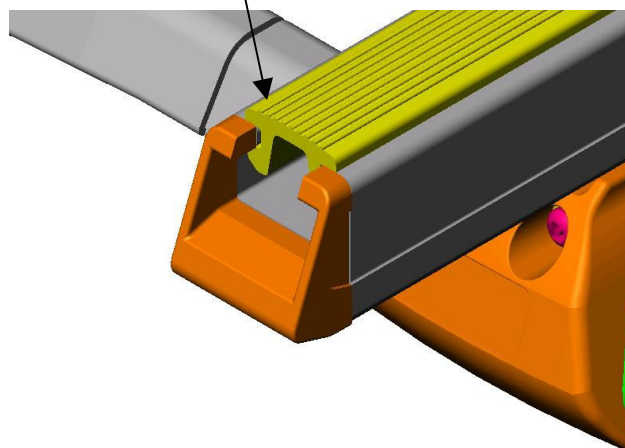

Fitting leg height spacers.

Leg height spacers can be fitted to level a three or four crossbar commercial rails roof rack system. To fit an existing system, the roof racks will need to be removed to fit the spacers. The fitting sequence for one or more spacers is the same.

Fitting one leg height spacer.

Slide the **type 1** spacer onto the outer clamp leg. Assemble the flat washer onto the M6 x 20 hex bolt, insert through the spacer and leg clamp and screw into the M6 nyloc nut. Replace the original crossbar attachment bolt with the longer M8 x 25 bolt as per the diagrams.

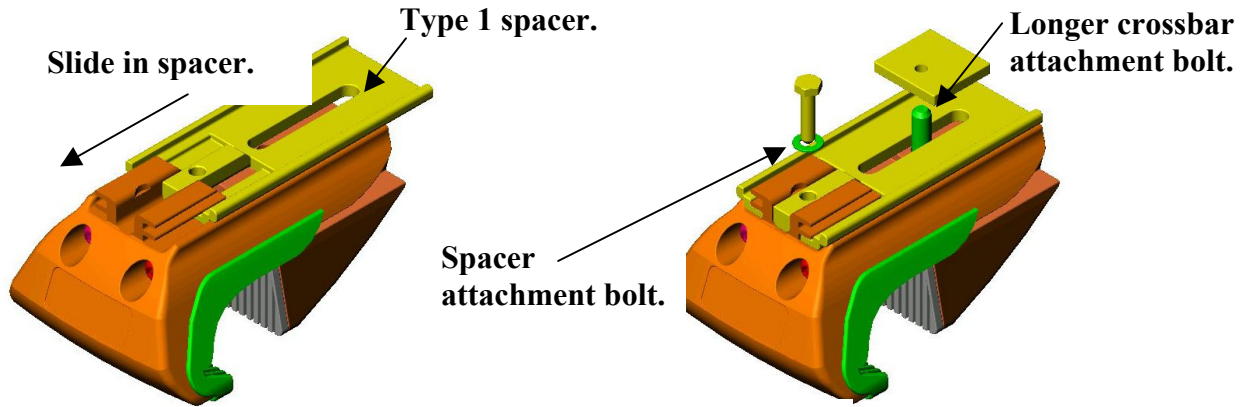

M6 nyloc spacer attachment nut.

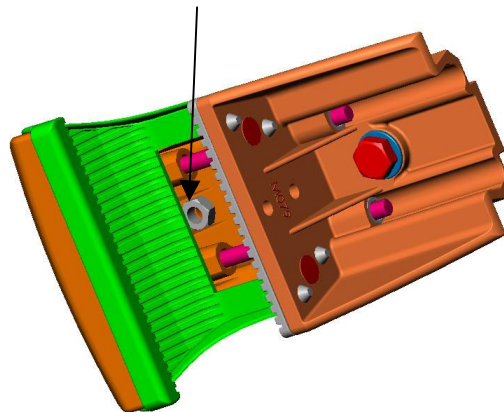

Two or more leg height spacers.

Slide the **Type 1** spacer used for a single crossbar lift onto the front clamp leg. (Refer the **one leg height spacer instruction** above). Slide the second **Type 2** spacer on top of the first spacer. Assemble the M6 flat washer onto the M6 x 30 hex bolt, insert through the spacers and leg clamp and screw into the M6 nyloc nut. Replace the original crossbar attachment bolt with a longer M8 x 35 bolt as per the diagrams.

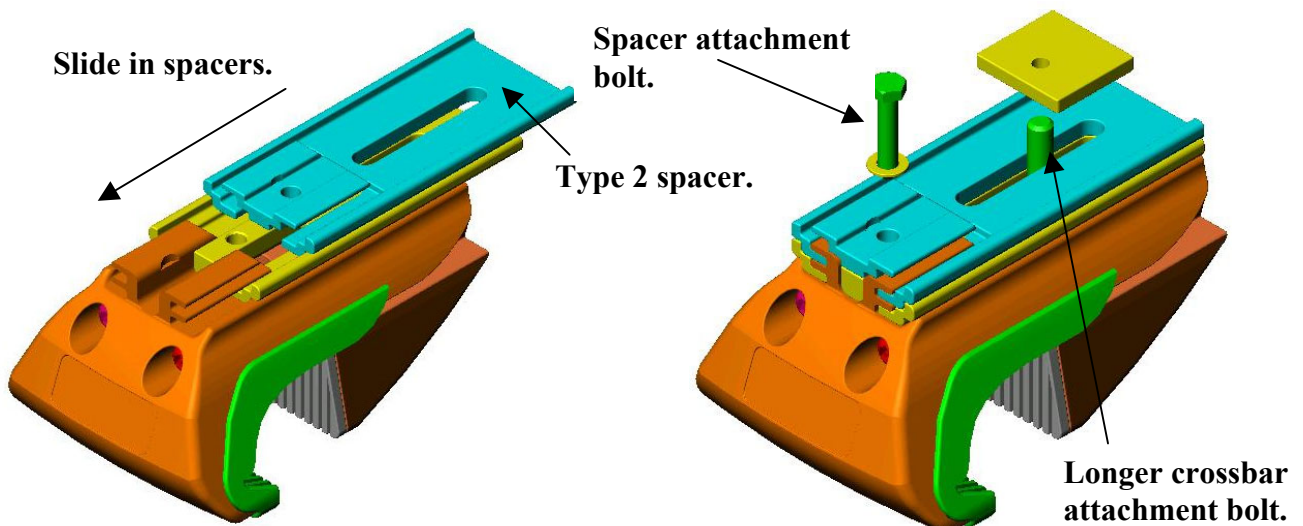

Fitting addition spacers is the same as the process as

fitting two spacers the first spacer being a **Type 1 spacer** followed by **Type 2 spacers**. For a three leg height spacer system the spacer bolt would be M6 x 35 and the crossbar attachment bolt would be M8 x 40. If fitting more than three spacers check the required bolt lengths before fitting.

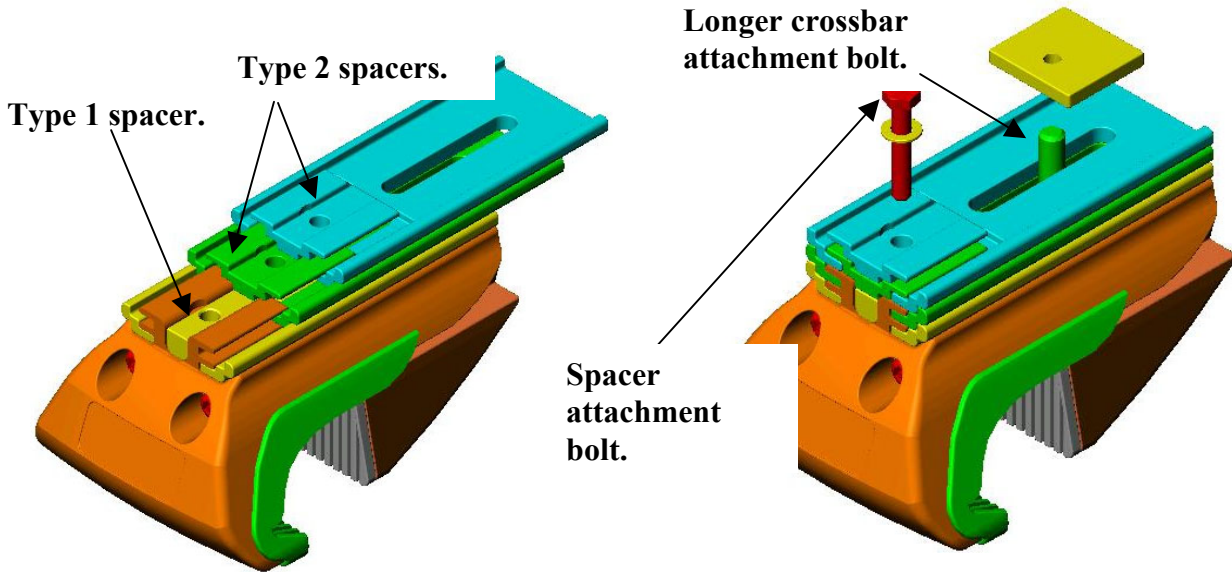

CXB FITTING INSTRUCTION FOR CROSSBAR OVERHANG GREATER THAN THE ALLEN KEY LENGTH.

Fit the CXB leg clamps and crossbar as per the above fitting instruction, except the crossbar attachment bolts are left loose.

Push crossbar across to access security clamp bolts with the Allen key.

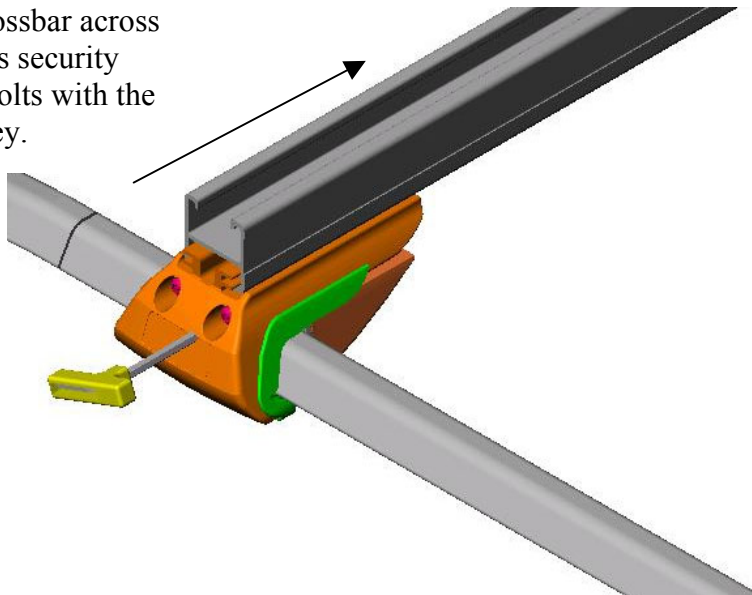

To access the leg clamp security bolts, push the crossbar across the vehicle until the security Allen key will access the security bolts. Using the security Allen key provided, tighten both leg clamp bolts equally, the outer clamp leg will move in towards the inner clamp leg. The leg assembly on some vehicles will lift as the security bolts are tightened. **Fully tighten the security bolts.** Check that the outer clamp leg rubber seal has folded out over the roof rails

Adjust the crossbar so that the over hang is equal both sides, and then fully tighten the crossbar attachment bolts, using a 13mm spanner. **Do not over tighten.**

Fit the end caps and rubber buffer strip .

RECOMMENDATIONS

Please refer to your vehicle manufactures operating manual for maximum roof load rating.

It is essential that all bolt connections be checked after driving a short distance when you first install your Rhino-Rails Crossbars. Bolt connections should be checked again at regular intervals (probably once a week is enough, depending on road conditions, usage, loads and distances travelled). You should also check the roof bars each time they are refitted.

Crossbars and accessories should be cleaned and all screw threads should be lubricated at regular intervals. Rhino-Rack offers a 3 Year warranty to the original purchaser of the Rhino Rails roof rack System and Accessories. Rhino-Rack cannot be held responsible for incorrect mounting of the roof rack System or for usage that exceeds vehicle and production tolerances.

Make sure to fasten your load securely. Please ensure that all loads are evenly distributed and that the centre of gravity is kept as low as possible. **Use only non-stretch fastening ropes or straps.**

SENSITIVITY TO CROSSWINDS, BEHAVIOUR IN CURVES AND BRAKING

The handling characteristics of the vehicle, changes when you transport a load on the roof. For safety reasons, we recommend you exercise extreme care when transporting wind-resisting loads; special consideration must be taken into account when braking.

PLEASE REMOVE CROSSBARS WHEN PUTTING VEHICLE THROUGH AN AUTOMATIC CAR WASH. LOAD RATINGS

The vehicle manufactures recommended load rating is the maximum permissible load per pair of roof racks (include the weight of the roof rack, 5kg). When roof bars are to be used in extreme off-road conditions please build a safety factor of 1.5 into this maximum load limit. Although roof bars are tested and approved to AS1235-2000, Australian road conditions can be much more rigorous. **Note for dealers and fitters.** It is your responsibility to ensure instructions are given to the end user or client.

**Manufactured by Rhino-Rack
17 Euston Street, Rydalmere,
NSW 2116, Australia
(Ph) 02 9638 4744 (Fax) 02 9638 4822**

RHINO - RACK	No: RR61
Prepared By: Alan Marshall	Issue No 01
Authorised By: Gary England	Issue Date: 26/09/01